

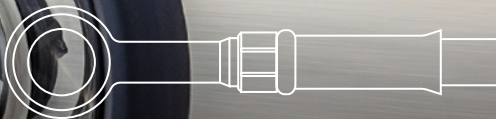

STEEL BRAIDED BRAKE LINES

2025



STEEL BRAIDED BRAKE LINES

HOSE CONSTRUCTION

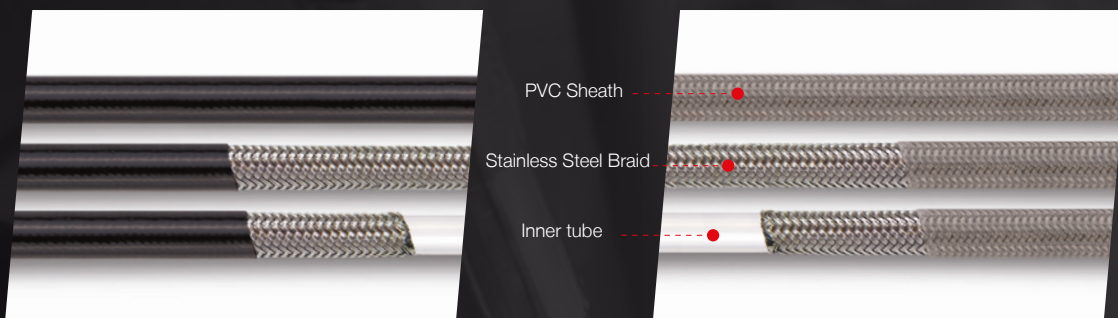

DEFINE THE LENGTH OF YOUR BRAKE LINE

The length of a steel braided brake line corresponds to the distance from female fitting to female fitting (see diagram opposite).

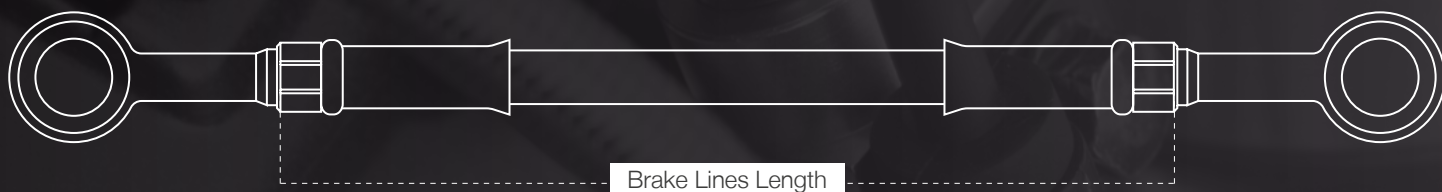

EASY INSTALLATION IN 2 STEPS

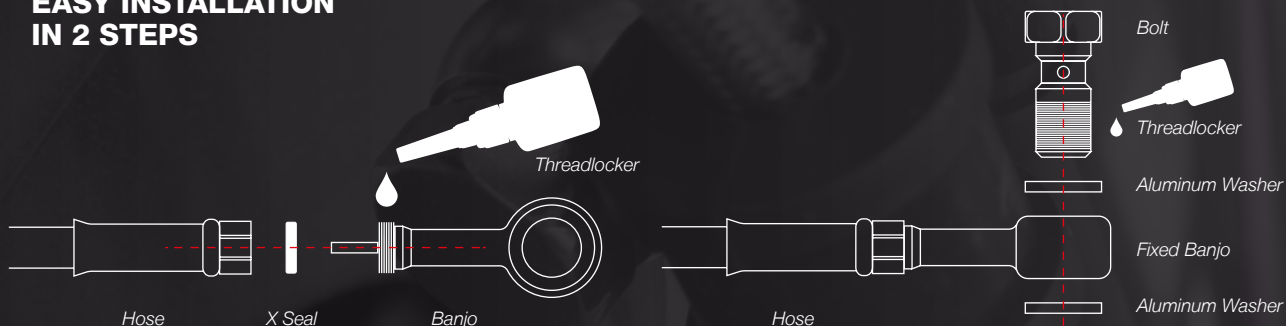

BRAKE HOSES | TECHNICAL INFORMATION

Inner tube:	Transparent PTFE	PTFE tube thickness:	0,9 mm
Outer braid:	Stainless steel AISI 304	Operating temperature range:	-75°C to +260°C
PVC sheath:	black or transparent	Tensile strength:	230 Kg
Inner Ø:	3,2 mm	Minimum bending radius:	25 mm
Outer Ø		Compatible brake fluids:	tout type (DOT 5 inclus)
• Bare stainless braid:	6,3 mm		
• With sheath:	7,3 mm		

STEEL BRAIDED BRAKE LINES

STEEL BRAIDED BRAKE LINES STABILITY & OPTIMAL BRAKING



STEEL BRAIDED BRAKE LINES

High-quality PTFE (Teflon) braided stainless steel brake line, ensuring powerful braking performance and extended durability.

BRAKE LINE LENGTH (mm)	BLACK-COATED HOSE	CLEAR-COATED HOSE
100	ALGS100NWM	ALGS100TWM
125	ALGS125NWM	ALGS125TWM
150	ALGS150NWM	ALGS150TWM
175	ALGS175NWM	ALGS175TWM
200	ALGS200NWM	ALGS200TWM
225	ALGS225NWM	ALGS225TWM
250	ALGS250NWM	ALGS250TWM
275	ALGS275NWM	ALGS275TWM
300	ALGS300NWM	ALGS300TWM
325	ALGS325NWM	ALGS325TWM
350	ALGS350NWM	ALGS350TWM
375	ALGS375NWM	ALGS375TWM
400	ALGS400NWM	ALGS400TWM
425	ALGS425NWM	ALGS425TWM
450	ALGS450NWM	ALGS450TWM
475	ALGS475NWM	ALGS475TWM
500	ALGS500NWM	ALGS500TWM
525	ALGS525NWM	ALGS525TWM
550	ALGS550NWM	ALGS550TWM
575	ALGS575NWM	ALGS575TWM
600	ALGS600NWM	ALGS600TWM
625	ALGS625NWM	ALGS625TWM
650	ALGS650NWM	ALGS650TWM
675	ALGS675NWM	ALGS675TWM
700	ALGS700NWM	ALGS700TWM
725	ALGS725NWM	ALGS725TWM

BRAKE LINE LENGTH (mm)	BLACK-COATED HOSE	CLEAR-COATED HOSE
750	ALGS750NWM	ALGS750TWM
775	ALGS775NWM	ALGS775TWM
800	ALGS800NWM	ALGS800TWM
825	ALGS825NWM	ALGS825TWM
850	ALGS850NWM	ALGS850TWM
875	ALGS875NWM	ALGS875TWM
900	ALGS900NWM	ALGS900TWM
925	ALGS925NWM	ALGS925TWM
950	ALGS950NWM	ALGS950TWM
975	ALGS975NWM	ALGS975TWM
1000	ALGS1000NWM	ALGS1000TWM
1025	ALGS1025NWM	ALGS1025TWM
1050	ALGS1050NWM	ALGS1050TWM
1075	ALGS1075NWM	ALGS1075TWM
1100	ALGS1100NWM	ALGS1100TWM
1125	ALGS1125NWM	ALGS1125TWM
1150	ALGS1150NWM	ALGS1150TWM
1175	ALGS1175NWM	ALGS1175TWM
1200	ALGS1200NWM	ALGS1200TWM
1225	ALGS1225NWM	ALGS1225TWM
1250	ALGS1250NWM	ALGS1250TWM
1275	ALGS1275NWM	ALGS1275TWM
1300	ALGS1300NWM	ALGS1300TWM
1325	ALGS1325NWM	ALGS1325TWM
1350	ALGS1350NWM	ALGS1350TWM
1375	ALGS1375NWM	ALGS1375TWM
1400	ALGS1400NWM	ALGS1400TWM
1425	ALGS1425NWM	ALGS1425TWM
1450	ALGS1450NWM	ALGS1450TWM
1475	ALGS1475NWM	ALGS1475TWM
1500	ALGS1500NWM	ALGS1500TWM



OFF-ROAD STEEL BRAIDED BRAKE LINES

High-quality stainless steel braided brake line, specially designed for off-road use and featuring an additional protective sheath.

BRAKE LINE LENGTH (mm)	BLACK-COATED HOSE
1100	ALGS1100TX
1150	ALGS1150TX
1200	ALGS1200TX
1250	ALGS1250TX
1350	ALGS1350TX

BRAKE LINE LENGTH (mm)	BLACK-COATED HOSE
1400	ALGS1400TX
1450	ALGS1450TX
1500	ALGS1500TX
1550	ALGS1550TX

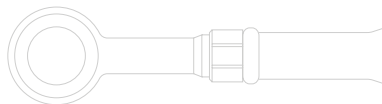

BANJOS & FITTINGS



THREE-WAY FITTINGS

HOCO #	ANGLE	TYPE	DIAMETER (mm)	MATERIAL
AL6595	-	Female	M10 x 100	Stainless Steel
AL4300	-	Male	-	Stainless Steel
AL5432	-	Male	-	Black Stainless Steel



FEMALE FITTINGS

HOCO #	ANGLE	TYPE	DIAMETER (mm)	MATERIAL
AL3713	-	-	M10 x 100	Stainless Steel
AL5421	-	-	M10 x 100	Black Stainless Steel
AL3716	-	-	M10 x 125	Stainless Steel
AL5422	-	-	M10 x 125	Black Stainless Steel
AL5426	-	Specific Female	3/8" x 24	Black Stainless Steel



MALE FITTINGS

HOCO #	ANGLE	TYPE	DIAMETER (mm)	MATERIAL
AL3704	90°	-	M10 x 100	Stainless Steel
AL3705	90°	-	M10 x 125	Stainless Steel
AL3714	-	-	M10 x 100	Stainless Steel
AL5409	-	-	M10 x 100	Black Stainless Steel
AL3715	-	-	M10 x 125	Stainless Steel
AL5410	-	-	M10 x 125	Black Stainless Steel
AL3725	-	Double	-	Stainless Steel



HARLEY-DAVIDSON SPECIFIC FITTINGS

HOCO #	ANGLE	TYPE	DIAMETER (mm)	MATERIAL
AL3721	-	Specific Male	3/8" x 24	Stainless Steel
AL3723	45°	Eye fitting	11	Stainless Steel
AL3724	90°	Eye fitting	11	Stainless Steel



CONVERSION FITTING

HOCO #	DESIGNATION
AL0065	Conversion fitting: concave to convex cone at the bottom of AL3713 and AL3716



STEEL BRAIDED BRAKE LINES

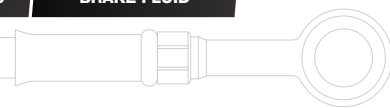

BANJOS | ALL DIFFERENT TYPES

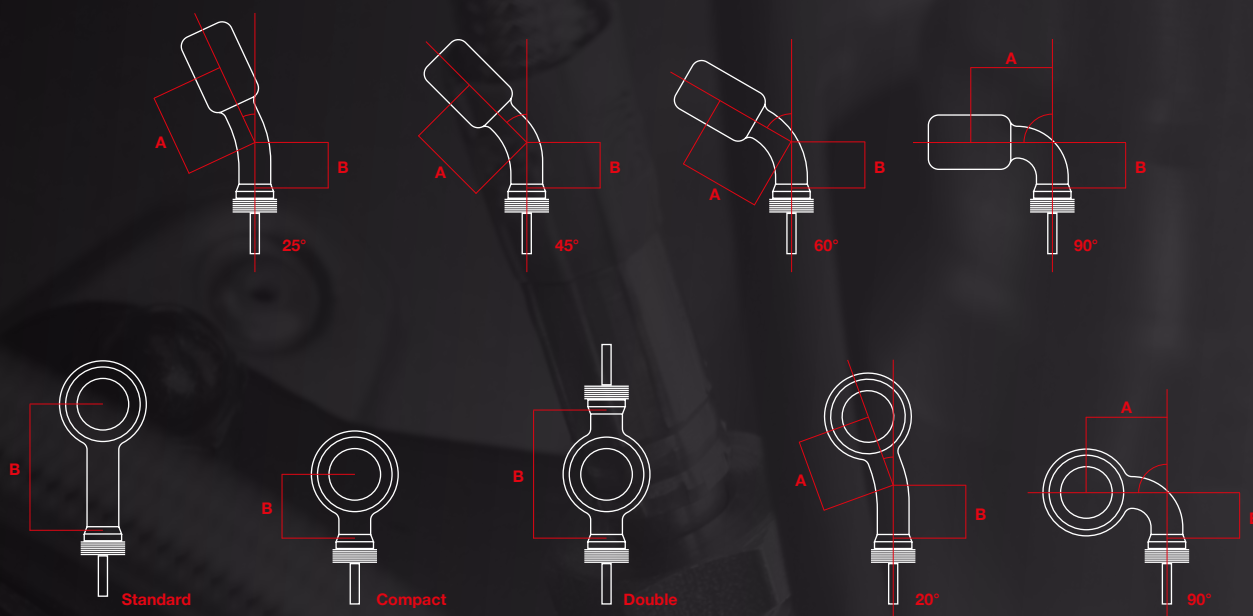

EYE FITTINGS

HOCO #	ANGLE	TYPE	SIZE A (mm)	SIZE B (mm)	EYE DIAMETER (mm)	MATERIAL
AL4481	Straight	-	-	24	8	Stainless Steel
AL0326	Straight	-	-	24	10	Stainless Steel
AL5393	Straight	-	-	24	10	Black Stainless Steel
AL0264	Straight	-	-	24	11	Stainless Steel
AL0128	Straight	Compact	-	10	10	Stainless Steel
AL5402	Straight	Compact	-	10	10	Black Stainless Steel
AL0078	Straight	Double	-	20	10	Stainless Steel
AL5405	Straight	Double	-	20	10	Black Stainless Steel
AL0773	20°	Flat	17	07	10	Stainless Steel
AL5404	20°	Flat	17	07	10	Black Stainless Steel
AL0350	25°	-	14	08	10	Stainless Steel
AL5396	25°	-	14	08	10	Black Stainless Steel
AL0314	45°	-	17	08	10	Stainless Steel
AL5397	45°	-	17	08	10	Black Stainless Steel
AL0339	60°	-	15	08	10	Stainless Steel
AL5399	60°	-	15	08	10	Black Stainless Steel
AL0325	90°	-	10	07	10	Stainless Steel
AL5400	90°	-	10	07	10	Black Stainless Steel
AL3780	90°	Flat	10	07	10	Stainless Steel



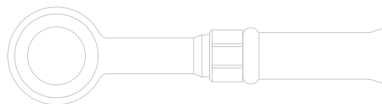

OIL PASSAGE BOLT

BANJO BOLT

HOCO #	LENGTH UNDER HEAD	SIZE	MATERIAL
SINGLE BANJO BOLT			
AL0426	17 mm	M8 x 100	Stainless Steel
AL0427	19 mm	M10 x 100	Stainless Steel
AL5522	19 mm	M10 x 100	Black Stainless Steel
AL0413	19 mm	M10 x 125	Stainless Steel
AL5523	19 mm	M10 x 125	Black Stainless Steel
DOUBLE BANJO BOLT			
AL0435	30 mm	M10 x 100	Stainless Steel
AL5526	30 mm	M10 x 100	Black Stainless Steel
AL2363	32,5 mm	M10 x 125	Stainless Steel
AL5527	32,5 mm	M10 x 125	Black Stainless Steel



WITH BLEEDER

HOCO #	LENGTH UNDER HEAD	SIZE	MATERIAL
SINGLE BANJO BOLT WITH BLEEDER			
AL2373	21 mm	M10 x 100	Stainless Steel
AL2392	21 mm	M10 x 125	Stainless Steel
DOUBLE BANJO BOLT WITH BLEEDER			
AL2364	32,5 mm	M10 x 100	Stainless Steel
AL2365	32,5 mm	M10 x 125	Stainless Steel



HARLEY-DAVIDSON SPECIFIC

HOCO #	LENGTH	SIZE	MATERIAL
AL1348	Courte	7/16" x 24	Stainless Steel
AL0414	Courte	3/8" x 24	Stainless Steel
AL0379	Longue	3/8" x 24	Stainless Steel



BRAKE LIGHT SWITCH BOLT



HOCO #	TYPE	THREAD
AL5269	single bolt	3/8" x 24
AL5280	single bolt	7/16" x 24
AL4501	single bolt	M10 x 100
AL4502	single bolt	M10 x 125
AL4503	single bolt	M10 x 100
AL4504	single bolt	M10 x 125

ACCESSORIES



HOCO #	DESIGNATION
AL2413	Brake line protective cap
AL4267	Bleeder cap for AL2373 and AL2392
AL0420	Aluminum washer Ø inner: 10 mm thickness: 1,5mm
AL0419	Aluminum washer Ø inner: 11 mm thickness: 1,5mm
AL3694	X-seal mounted between hose and fitting
AL0182	Rubber sleeve

STEEL BRAIDED BRAKE LINES



BRAKE FLUID



DOT 4



500 ml LM3093
5L LM21158

SL6 DOT 4



LM21167

Suitable for ABS and ASR systems
(SL6 standard)

DOT 5.1



LM21160

Suitable for ABS systems



DOT 4



500 ml 830274040
1L 830270037
15L 830274574

DOT 4 RACING



830274041

Designed for competition, boiling
point 328°C

DOT 5



830274042

Silicone-based, suitable for hydraulic
brake and clutch systems

DOT 5.1



830274043

DOT 5.1 brake fluid is a high-quality
synthetic brake fluid



DOT 4



1L 830115CD1C
5L 830115CD1B

DOT 4



830115CC7A

RACING



830115C540



*Find all brands at
www.hocoparts.com*